

**vtech**<sup>®</sup>  
Baby

# Parent's Guide

## Lil' Critters Soothing Starlight Polar Bear™



# INTRODUCTION

Thank you for purchasing the **VTech® Lil' Critters Soothing Starlight Polar Bear™**. Soothe your baby to sleep while the soft polar bear projects stars onto the ceiling in four different colors while playing calming sounds, songs and seven nursery rhymes.

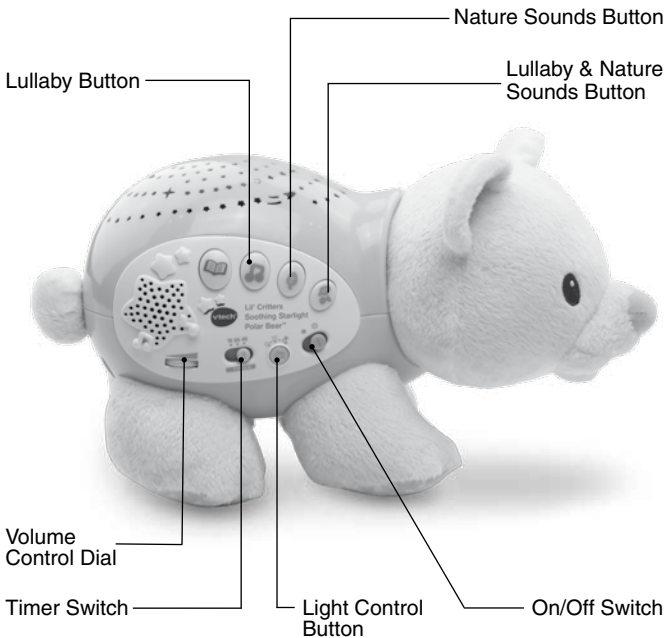

# INCLUDED IN THIS PACKAGE

- One Lil' Critters Soothing Starlight Polar Bear™
- One parent's guide

**WARNING:** All packing materials such as tape, plastic sheets, packaging locks, removable tags, cable ties and packaging screws are not part of this toy, and should be discarded for your child's safety.

**ATTENTION:** Pour la sécurité de votre enfant, débarrassez vous de tous les produits d'emballage tels que rubans adhésifs, feuilles de plastique, attaches et étiquettes. Ils ne font pas partie du jouet.

**NOTE:** Please keep this parent's guide as it contains important information.

## GETTING STARTED

### Battery Installation

1. Make sure the unit is turned **OFF**.
2. Locate the battery cover on the bottom of the polar bear. Use a screwdriver to loosen the screw.
3. Install 2 new AA (AM-3/LR6) batteries following the diagram inside the battery box. (The use of new alkaline batteries is recommended for maximum performance).
4. Replace the battery cover and tighten the screw to secure.

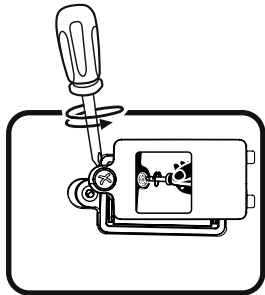

## Battery Notice

- Use new alkaline batteries for maximum performance.
- Use only batteries of the same or equivalent type as recommended.
- Do not mix different types of batteries: alkaline, standard (carbon-zinc) or rechargeable, or new and used batteries.
- Do not use damaged batteries.
- Insert batteries with the correct polarity.
- Do not short-circuit the battery terminals.
- Remove exhausted batteries from the toy.
- Remove batteries during long periods of non-use.
- Do not dispose of batteries in fire.
- Do not charge non-rechargeable batteries.
- Remove rechargeable batteries from the toy before charging (if removable).
- Rechargeable batteries are only to be charged under adult supervision.

## PRODUCT FEATURES

### 1. On/Off Switch

To turn the unit **ON**, slide the **On/Off Switch** to the **ON**(⏻) position.  
To turn the unit **OFF**, slide the **On/Off Switch** to the **OFF** (●) position.

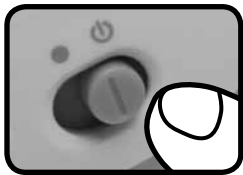

### 2. Timer Switch

Slide the **Timer Switch** to select the length of time the unit will play. When the time is up the unit will automatically shut down.



### 3. Volume Control Dial

Turn the **Volume Control Dial** to select the desired volume.

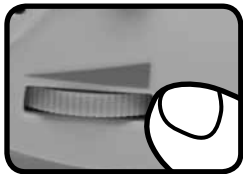

### 4. Light Control Button

Press the **Light Control Button** to select one of six light effects. Press the button until you find the desired setting.

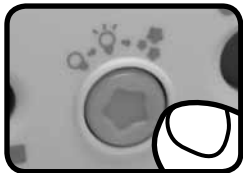

### 5. Mode Buttons

Press one of the four **Mode Buttons** to choose a mode of play.



### 6. Automatic Shut Off

To preserve battery life, the **Lil' Critters Soothing Starlight Polar Bear™** will automatically shut down after the selected time. The unit can be turned on again by pressing any button or when the sound sensor detects your baby's cry.

### 7. Sound Sensor

The **Lil' Critters Soothing Starlight Polar Bear™** is equipped with a special sound sensor. Once the selected time setting has ended, the unit will automatically shut down. The sensor will reactivate the program when it detects your baby's cry for approximately four seconds without interruption. The unit will reactivate and play lullabies and nature sounds.

## Note:

This product is in Try Me mode in the packaging. After opening the package, remove the Try Me tag from the bottom of the product, and then turn the unit off and on again to proceed with normal play.

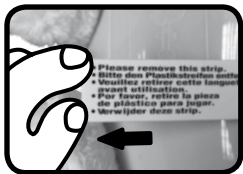

## ACTIVITIES

### 1. Story Button

Press the **Story Button** to hear seven stories with fun sounds followed by soft melodies. Press the story button again to hear the next story or melody. The light pattern will fade in and fade out slowly with the sounds, if the light control button has not been pressed.



### 2. Lullaby Button

Press the **Lullaby Button** to hear three soothing songs followed by soft melodies. Press the lullaby button again to hear the next song or melody. The light pattern will fade in and fade out slowly with the sounds, if the light control button has not been pressed.

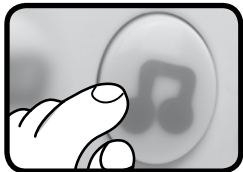

### 3. Nature Sounds Button

Press the **Nature Sounds Button** to hear a combination of soothing nature sounds. Press the nature sound button again to hear the next sound. The light pattern will fade in and fade out slowly with the sounds, if the light control button has not been pressed.



## 4. Lullaby & Nature Sounds Button

Press the **Lullaby & Nature Sounds Button** to hear soothing melodies with nature sounds. Press the lullaby and nature sound button again to hear the next melody. The light pattern will fade in and fade out slowly with the sounds, if the light control button has not been pressed.

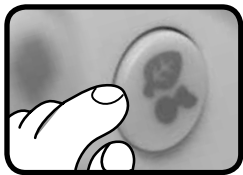

### SING-ALONG SONGS

1. Row, Row, Row Your Boat
2. Rock-a-Bye Baby
3. Twinkle, Twinkle Little Star

### MELODY LIST

1. Diddle, Diddle, Dumpling
2. To Market, To Market
3. Roses Are Red
4. Lavender's Blue
5. Polly Put the Kettle On
6. Hickory Dickory Dock
7. Ring Around the Rosy
8. Frère Jacques
9. Oh, Dear! What Can the Matter Be?
10. Where Has My Little Dog Gone?
11. Riddle Song
12. Good Morning Merry Sunshine
13. Teddy Bears' Picnic
14. Toyland
15. Bicycle Built For Two
16. Go Tell Aunt Rhody
17. Ride a Cock Horse to Banbury Cross

18. Sailing, Sailing
19. Grandfather's Clock
20. Oranges and Lemons
21. All the Pretty Little Horses
22. Little Bo Peep
23. Beautiful Dreamer
24. Au Claire de la Lune
25. Home Sweet Home
26. Serenade
27. Menuet
28. All Through the Night
29. Magic Flute
30. Irish Lullaby
31. New World Symphony
32. Rondo a Capriccio
33. To a Wild Rose
34. Canon in D
35. Happy Farmer
36. Lullaby
37. Hush Little Baby
38. Sleep, Baby, Sleep
39. Alouette
40. Jesu, Joy Of Man's Desiring
41. Für Elise
42. Klipp Klopp Gallop
43. Four Seasons - Winter
44. Four Seasons - Fall
45. Four Seasons - Spring
46. Four Seasons - Summer
47. Twinkle, Twinkle Little Star
48. Rock-a-Bye Baby
49. Air for the G String
50. Shenandoah
51. Piano Sonata in C, K545, 1st Movement



52. Minuet in G
53. Kinderscene
54. Spring Song
55. Waltz of the Flowers
56. Sleeping Beauty Waltz
57. Eine Kleine Nachtmusik
58. Greensleeves
59. Moonlight Sonata
60. Ode To Joy

## CARE & MAINTENANCE

1. Keep the unit clean by wiping it with a slightly damp cloth.
2. Keep the unit out of direct sunlight and away from any direct heat source.
3. Remove the batteries when the unit will not be in use for an extended period of time.
4. Do not drop the unit on hard surfaces and do not expose the unit to moisture or water.

## TROUBLESHOOTING

If for some reason the unit stops working or malfunctions, please follow these steps:

1. Please turn the unit **OFF**.
2. Interrupt the power supply by removing the batteries.
3. Let the unit sit for a few minutes, then replace the batteries.
4. Turn the unit **ON**. The unit should now be ready to play again.
5. If the unit still does not work, replace with an entire set of new batteries.

If the problem persists, please call our Consumer Services Department at 1-800-521-2010 in the U.S. or 1-877-352-8697 in Canada, or by going to our website at [vtechkids.com](http://vtechkids.com) and filling out our Contact Us form located under the Customer Support link. A service representative will be happy to help you.

**IMPORTANT NOTE:**

Creating and developing VTech® products is accompanied by a responsibility that we at VTech® take very seriously. We make every effort to ensure the accuracy of the information, which forms the value of our products. However, errors sometimes can occur. It is important for you to know that we stand behind our products and encourage you to call our Consumer Services Department on at 1-800-521-2010 in the U.S. or 1-877-352-8697 in Canada, or by going to our website at [vtechkids.com](http://vtechkids.com) and filling out our Contact Us form located under the Customer Support link with any problem and/or suggestions that you might have. A service representative will be happy to help you.

**Note:**

This equipment has been tested and found to comply with the limits for a Class B digital device, pursuant to Part 15 of the FCC Rules. These limits are designed to provide reasonable protection against harmful interference in a residential installation. This equipment generates, uses and can radiate radio frequency energy and, if not installed and used in accordance with the instructions, may cause harmful interference to radio communications. However, there is no guarantee that interference will not occur in a particular installation. If this equipment does cause harmful interference to radio or television reception, which can be determined by turning the equipment off and on, the user is encouraged to try to correct the interference by one or more of the following measures:

- Reorient or relocate the receiving antenna.
- Increase the separation between the equipment and receiver.
- Connect the equipment into an outlet on a circuit different from that to which the receiver is connected.
- Consult the dealer or an experienced radio/TV technician for help.

THIS DEVICE COMPLIES WITH PART 15 OF THE FCC RULES. OPERATION IS SUBJECT TO THE FOLLOWING TWO CONDITIONS: (1) THIS DEVICE MAY NOT CAUSE HARMFUL INTERFERENCE, AND (2) THIS DEVICE MUST ACCEPT ANY INTERFERENCE RECEIVED, INCLUDING INTERFERENCE THAT MAY CAUSE UNDESIREED OPERATION.

*CAN ICES-3 (B)/NMB-3(B)*

**Caution:** Changes or modifications not expressly approved by the party responsible for compliance could void the user's authority to operate the equipment.





## PRODUCT WARRANTY

This Warranty is applicable only to the original purchaser, is non-transferable and applies only to "VTECH" products or parts. This product is covered by a 3-month Warranty from the original purchase date, under normal use and service, against defective workmanship and materials. This Warranty does not apply to (a) consumable parts, such as batteries; (b) cosmetic damage, including but not limited to scratches and dents; (c) damage caused by use with non-VTECH products; (d) damage caused by accident, misuse, unreasonable use, immersion in water, neglect, abuse, battery leakage, or improper installation, improper service, or other external causes; (e) damage caused by operating the product outside the permitted or intended uses described by VTECH in the owner's manual; (f) a product or part that has been modified (g) defects caused by normal wear and tear or otherwise due to the normal aging of the product; or (h) if any VTECH serial number has been removed or defaced.

Prior to returning a product for any reason, please notify the VTECH Consumer Services Department by going to our website at [vtechkids.com](http://vtechkids.com), filling out our Contact Us form located under the Customer Support link or calling 1-800-521-2010.

If the service representative is unable to resolve the issue, you will be provided instructions on how to return the product and have it replaced under Warranty. Return of the product under Warranty must adhere to the following rules: If VTECH believes that there may be a defect in the materials or workmanship of the product and can confirm the purchase date and location of the product, we will at our discretion replace the product with a new unit or product of comparable value. A replacement product or parts assumes the remaining Warranty of the original product or 30 days from the date of replacement, whichever provides longer coverage.

**THIS WARRANTY AND THE REMEDIES SET FORTH ABOVE ARE EXCLUSIVE AND IN LIEU OF ALL OTHER WARRANTIES, REMEDIES AND CONDITIONS, WHETHER ORAL, WRITTEN, STATUTORY, EXPRESS OR IMPLIED. IF VTECH CANNOT LAWFULLY DISCLAIM STATUTORY OR IMPLIED WARRANTIES THEN TO THE EXTENT PERMITTED BY LAW, ALL SUCH WARRANTIES SHALL BE LIMITED TO THE DURATION OF THE EXPRESS WARRANTY AND TO THE REPLACEMENT SERVICE AS DETERMINED BY VTECH IN ITS SOLE DISCRETION.**

To the extent permitted by law, VTECH will not be responsible for direct, special, incidental or consequential damages resulting from any breach of Warranty.

**This Warranty is not intended to persons or entities outside the United States of America. Any disputes resulting from this Warranty shall be subject to the final and conclusive determination of VTECH.**

**Visit our website for more  
information about our products,  
downloads, resources and more.**

***vtechkids.com***



TM & © 2017 VTech Holdings Limited.  
All rights reserved.  
**Printed in China.**  
91-003334-006 (US)